

Naval Base Pier Catwalks

Client: CBM International

ideas^o
smart thinking

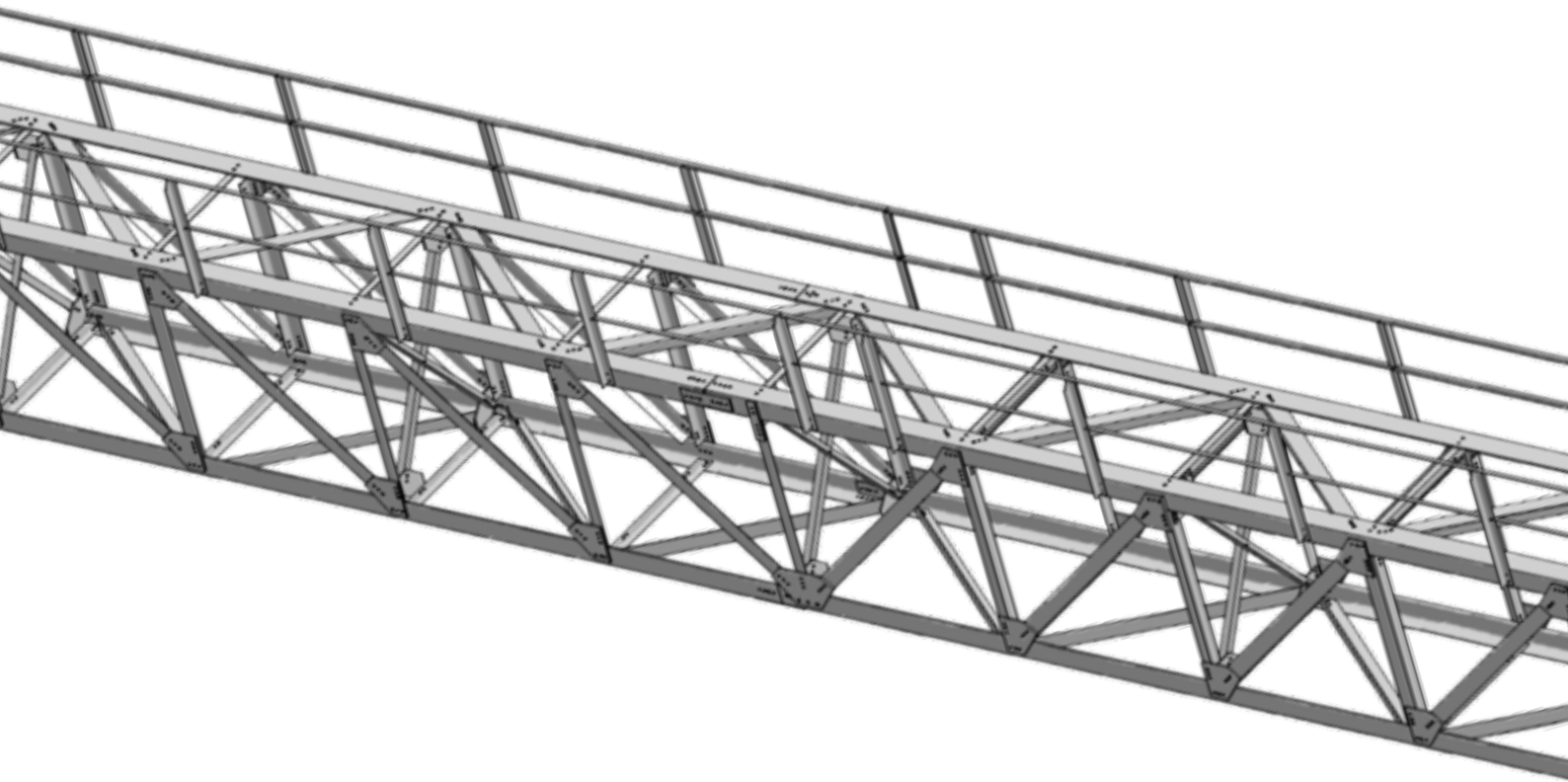

ideas* was commissioned by Apollotec Engineering to create fabrication drawings for 23 new catwalks for use between piers at a US naval base in Guam.

The main challenge was to design the structure so that it could be easily flat packed for shipping from Australia to the USA.

The design featured full aluminium girder construction with stainless steel bolted joints, removing the need for any onsite welding.

The uniform design was used to fit various sized catwalk lengths.

The design also included custom aluminium extrusions for the top and bottom stringers. These materials were chosen for their high resistance to corrosion and low weight.

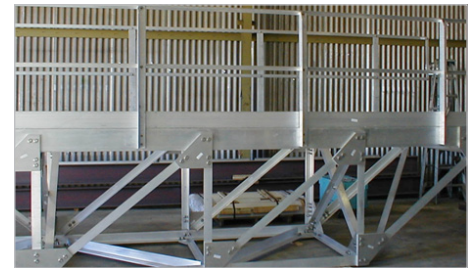

The complete fabricated catwalk produced by Apollotec Engineering.